

October 2021

Parking Scheme Consultation



CHANTRY ROAD AREA Parking Review

PUBLIC CONSULTATION

IMPORTANT – THIS AFFECTS YOU – PLEASE RESPOND

Chantry Road Area Parking Review

Introduction

In November 2020 the council received a petition from the residents of Chantry Road and West Chantry, requesting the council to extend the existing controlled parking zone (CPZ) (Z) operational Monday to Friday 10am to 3pm to include Chantry Road and West Chantry.

The petition was considered at the annual parking review meeting of the Traffic and Road Safety Advisory Panel (TARSAP) in March 2021. At this meeting the Panel agreed to include the Chantry Road area in Hatch End in the council's parking programme for 2021-22, as detailed in the attached plan.

The council is therefore consulting everyone within the consultation area to establish if they are experiencing any parking problems and whether they would support the extension of zone (Z) in the adopted sections of Chantry Road and Chantry Place, which can be controlled and regulated by the council. Parking controls cannot be extended to include West Chantry as this is an unadopted road.

This review will enable officers to identify the problems and introduce parking controls that will help control and regulate parking in the uncontrolled adopted roads which will help remove non-resident parking during the controlled hours freeing up road space for the local residents.

The council wants your views about parking problems in your area

The council is seeking the views of the local residents/businesses to get a better understanding of the parking problems being experienced and whether there is support for the extension of zone (Z) in the adopted sections of Chantry Road and Chantry Place.

The introduction of a new CPZ and or the extension of an existing CPZ is a two-stage process.

Stage One – is an informal public consultation intended to gather information from local residents and businesses about parking problems on your road to help the council decide what measures if any are taken forward to the next stage.

Stage Two – is the legal notification (statutory consultation) stage, when residents and businesses are re-consulted on the proposed parking controls to be taken forward.

We are currently at the informal **Stage One** process. **No decisions** have yet been made.

Although some people have contacted us to explain their parking problems, we would like to hear your views as well. Your views are very important so that the council can clearly understand the level of support that exists for parking controls within your area. If there is majority support for parking controls the council will proceed to **Stage Two** which is the Legal Notification (statutory consultation) stage.

Once this parking review is completed, it is unlikely that another review will occur in this area for several years due to outstanding requests from other areas of the borough. It is important that you tell us about any parking issues you may have now so that we can try to address them within this review.

How do you decide what to do?

You should consider whether the parking issues you experience in your street justify the extension of the existing zone (Z) to include your road. A CPZ provides parking opportunities for residents

and their visitors but involves the purchase of a resident and or visitors parking permit to enable them to park on street during the controlled hours. Should you want to be included in zone (Z) the existing hours of control should reflect the level of parking problems in the area balanced against the flexibility of having visitors outside the controlled hours.

You must decide what is important for you. We will analyse all the responses we receive, and parking controls will only be implemented where there is clear majority support. The results of the consultation will be referred to the next available TARSAP meeting and /or Portfolio Holder (PH) for Environment for approval to proceed to the next stage which is the Legal Notification (statutory consultation) stage (**Stage Two**).

If the scheme progresses to this stage the council will write to you again with further information about this stage of the process.

What do you need to do now?

We are aware that not everyone is of the same view and therefore have enclosed a questionnaire for you to complete in private. The information you provide will be analysed along with all other comments received. We are asking you questions about any parking problems you may be experiencing and whether you support the extension of zone (Z).

The council is encouraging the use of its online consultation portal on the Harrow council website and we would prefer you to respond on-line as it is more environmentally friendly and helps the council to save costs. You can submit your questionnaire on-line by visiting:

www.harrow.gov.uk/trafficconsultations.

You then click on the link for the '**Chantry Road Area Parking Review**' and click on '**Respond by filling in the online questionnaire**' to make your comments. You will be asked to register your details before completing the survey. Alternatively, you can send the completed questionnaire by post to:

Head of Traffic, Highways and Asset Management
Harrow Council , PO Box 39, Civic Centre, Harrow HA1 2XA.

The public consultation will run for a period of 21 days between **15th October 2021** and **4th November 2021**.

All responses should be received by no later than 4th November 2021.

Can I discuss this with an officer?

Yes. If you would like to discuss any aspect of this consultation in more detail please contact: Transportation@Harrow.gov.uk and an officer will respond.

Parking permit charges

Central government requires parking schemes to be self-financing, so monies raised in operating and enforcing schemes pays for the installation, parking attendants, the costs of processing parking fines, issuing permits, maintenance and other associated costs.

The current annual resident parking permit costs in Harrow are now based on vehicle emissions or engine capacity and are reviewed annually. The council moved to a charging regime that

Chantry Road Area Parking Review

incentivises lower or zero levels of emissions to address the impact of emissions on climate change and improve air quality and the environment. Please refer to table below:

For cars registered after 1 March 2001, use CO2 emissions For cars registered before 1 March 2001, use engine capacity Pricing for diesel vehicles in the categories below are represented in brackets				
	1st vehicle	2nd vehicle	3rd vehicle	4 th and subsequent vehicles
Electric only vehicles	£20.60		£25.80	£32
CO2 emissions rated up to 150g/km, or engine capacity up to 1,299cc	£51.50 (£62)	£77.50 (£93)	£103 (£123.50)	£129 (£154.50)
CO2 emissions rated between 151g/km up to 185g/km, or engine capacity between 1,300cc and 1,849cc	£62 (£74)	£93 (£111.50)	£123.50 (£148.50)	£154.50 (£185.50)
CO2 emissions rated between 186g/km up to 225g/km, or engine capacity between 1,850cc and 2,449cc	£72 (£86.50)	£108 (£130)	£144 (£173)	£180 (£216.50)
CO2 emissions rated over 226g/km, or engine capacity greater than 2,450cc	£82.50 (£99)	£123.50 (£148)	£165 (£198)	£206 (£247)

If you own a hybrid vehicle that uses both electric and fossil fuel as its source of power, then the charges will be based on the maximum vehicle emissions rating for the vehicle.

Visitor permits are £20.90 per book of 10, which is reduced to half price for senior citizens or those receiving mobility benefits if the discount is claimed. Blue badge displaying vehicles can park for free.

Please note whilst parking permits do offer preferential parking during the controlled times, they do not guarantee a parking space. You only need to buy a resident and or visitors parking permit if you intend to park the vehicle on the road during the controlled times.

Further information about parking permits; including costs for Doctor (GP), business and traders permits; can be found on the following link: <https://www.harrow.gov.uk/parking-permits>

CHANTRY ROAD AREA

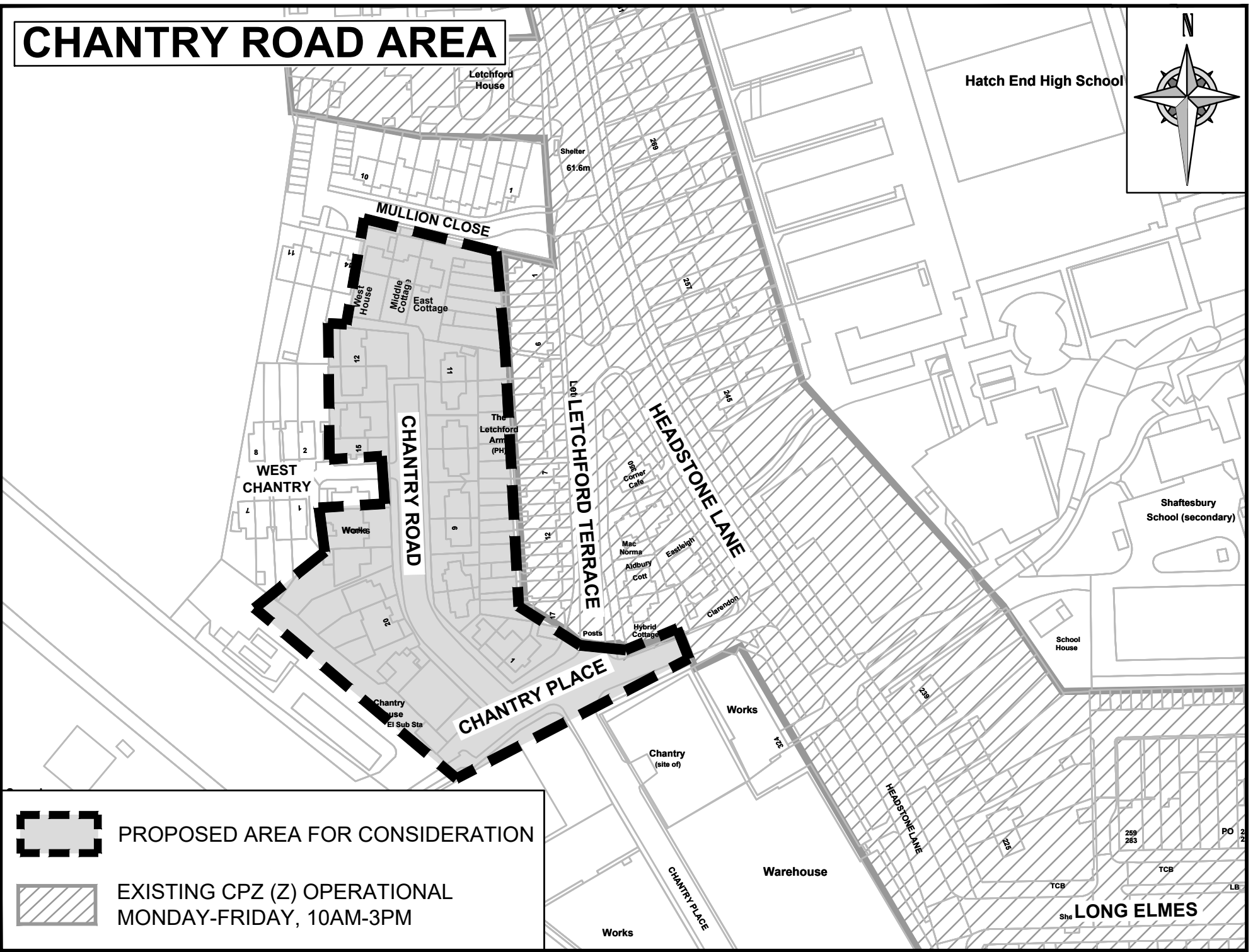
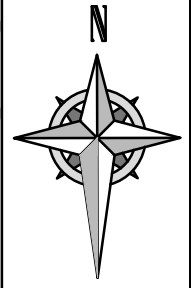

PROPOSED AREA FOR CONSIDERATION



EXISTING CPZ (Z) OPERATIONAL
MONDAY-FRIDAY, 10AM-3PM